



Sakura Gomon Restoration and Improvement Work

Progress of Construction

Construction, which began with the procurement and processing of timber, took a total of 31 months to complete, six months longer than originally planned, due in part to COVID-19.

Construction Schedule

Fiscal Year (FY)		FY 2019			FY 2020							FY 2021							FY 2022			Remarks					
Month		Dec.	Jan.	Feb.	Mar.	Apr.	May	Jun.	Jul.	Aug.	Sep.	Oct.	Nov.	Dec.	Jan.	Feb.	Mar.	Apr.	May	Jun.	Jul.		Aug.	Sep.	Oct.	Nov.	Dec.
Preliminary Preparations																											
Preparatory Works	Infrastructure Development																										
	Installation/Dismantling of Temporary Office																										
Temporary Works	Assembly/Dismantling of External Scaffolding																										
	Installation/Dismantling of Temporary Roof																										
Foundation Work	Foundation Work																										
Woodworking	Producing Construction Drawings / Full Scale Drawing																										
	Lumber Procurement and Drying / Cutting																										
	Wood Mill Processing																										
	Post and Beam Framing																										
	Eaves / Horizontal Structure																										
	Rough Wall Arrangement																										
	Roofing Board																										
	Interior/Exterior Works																										
	Finishing Various Parts																										
	Plaster Work	Procure Clay Wall Materials																									
Production/Curing Clay Walls																											
Rough Coating to Plastering Walls																											
Plastering around Fixtures																											
Roofing	Roof Tile Production																										
	Roofing																										
Joinery Work	Fabrication/Fitting of Fixtures																										
	Erection of Fixtures																										
Ornamental Metal Work	Fabrication of Metal Parts																										
	Installation of Metal Parts																										
Exterior Construction	Exterior Construction																										
Electrical Installation Work	Electrical Installation Work																										
Organize Documents	Completion Documentation																										

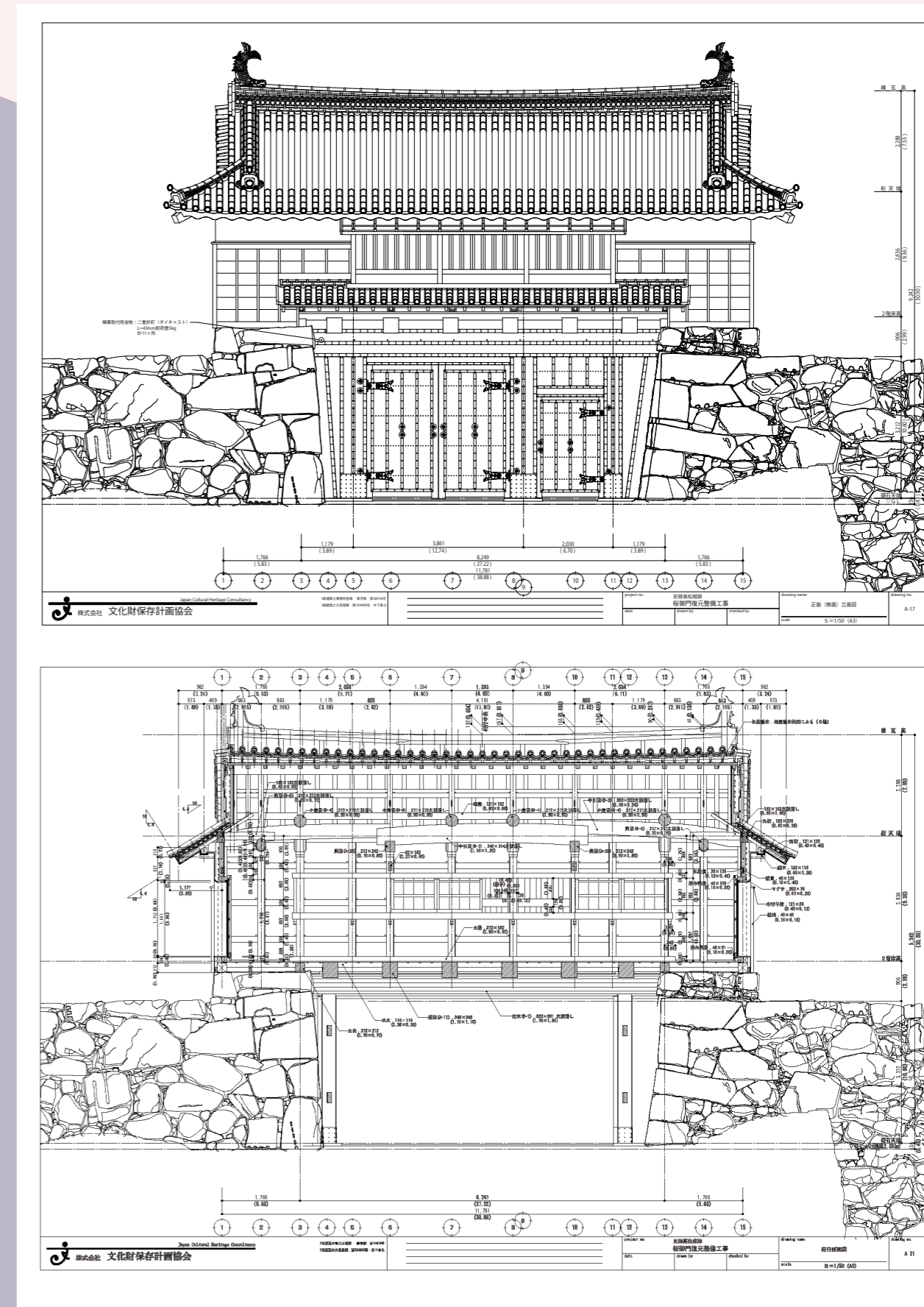

Construction Blueprints (partial)

Craftsmen's Handiwork

Many craftsmen, including carpenters, tilers, plasterers, and stonemasons, were involved in the construction exercising their knowledge and skills. While using modern tools, such as heavy machinery and power tools, careful handiwork was done with a strong awareness of Edo Period (1603-1867) and the texture (landscape) of the structure. Look for the modern craftsmanship, which can be seen here and there. It has made it possible to restore this historic gate.



Making Roof Tiles



Assemble Wood



Roofing Tiles



Plastering

